

REMOVABLE CAP  
POLE SHAFT

DRILLED PER FIXTURE REQUIREMENTS:  
D1- DRILLED FOR 1 FIXTURE  
D2- DRILLED FOR 2 FIXTURES AT 90° & 180°  
D3- DRILLED FOR 3 FIXTURES  
D4- DRILLED FOR 4 FIXTURES

### DRILL MOUNT OPTIONS

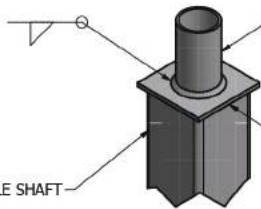

TENON MOUNT OPTIONS:  
T2- Ø2.38 OD X 4.00 LG  
T2.5 - Ø2.88 OD X 4.00 LG  
T3- Ø3.00 OD X 5.00 LG  
T4- Ø4.00 OD X 6.00 LG

POLE SHAFT  
.25 THK. TENON MOUNT

### TENON MOUNT OPTIONS

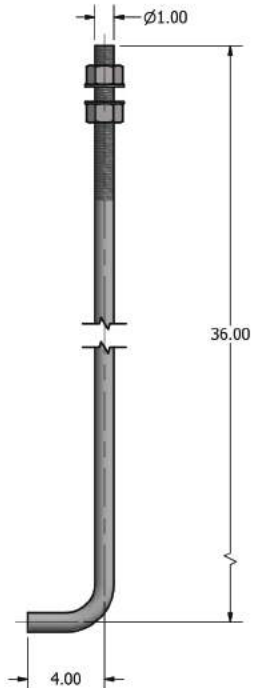

Ø1.00 X 40.00 ANCHOR BOLT

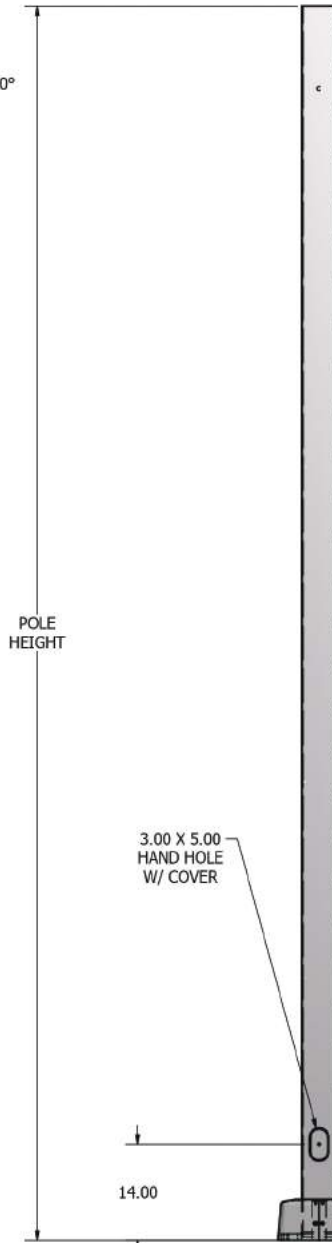

POLE DETAIL

POLE SPECIFICATIONS					
NO.	COMPONENT	ASTM DESIGNATION	MIN. YIELD (P.S.I)		
1.	POLE SHAFT	A-500 GR. B	46,000		
2.	BASE PLATE	A36	36,000		
3.	ANCHOR BOLTS	F1554 GR. 55	55,000		
4.	GALVANIZED HARDWARE	A153	-		
FINISH SPECIFICATIONS					
POLES SHALL HAVE A POLYESTER POWDER COAT FINISH IN A STANDARD COLOR.					
POLE DIMENSIONS					
POLE HGT. (FT.)	TOP SQ. SIZE (IN.)	BOT. SQ. SIZE (IN.)	GAGE	MTG. HGT. (FT.)	
20'	5.00	5.00	7 GAGE	20'	
BASE PLATE DIMENSIONS					
BOLT CIRCLE (IN.)	BASE PLATE DIM. (IN.)	BOLT HOLE (IN.)	PLATE THK. (IN.)		
10.50-11.50	11.00 SQ	1.25	1.00		
ANCHOR BOLT DIMENSIONS					
ANCHOR BOLT DIA. (IN.)		ANCHOR BOLT LENGTH (IN.)			
1.00		40.00			
ALLOWABLE WIND LOADING (SQ. FT.)					
WIND* EPA	INDICATED EPA	80 MPH	90 MPH	100 MPH	120 MPH
-	-	26.4	21.3	17.2	12.1

\*WITH 1.3 GUST FACTOR



3.00 X 5.00 HAND HOLE COVER

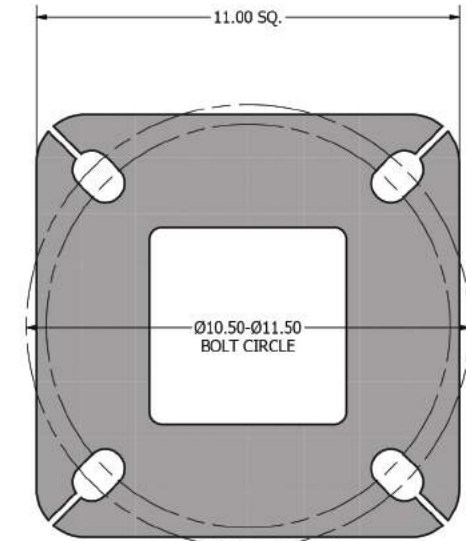

11.00 X 11.00 X 1.00 THK. BASE PLATE

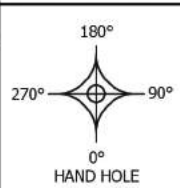

DRAWN:	5/28/2015
CHECKED:	
REVISION:	DATE:
APPROVED:	
QUOTE:	
S.O.#	
REF:	SCALE: NONE



SOME GEOGRAPHICAL AREAS HAVE SPECIAL WIND CONDITIONS THAT CAN CREATE WIND INDUCED VIBRATIONS CAUSING A FATIGUE PROBLEM. NO METHOD HAS YET BEEN FOUND FOR PREDICTING DESTRUCTIVE LIGHTING POLE VIBRATION. THESE CONDITIONS ARE UNIQUE AND CANNOT BE GUARANTEED AGAINST, AND ARE THE RESPONSIBILITY OF A LOCAL SITE ENGINEER.

TITLE:	
CATALOG:	U-SSSS-20-5-7
DWG NO:	SIZE: C SHEET 1 OF 1