

REMOVABLE CAP
POLE SHAFT

DRILLED PER FIXTURE REQUIREMENTS:
D1- DRILLED FOR 1 FIXTURE
D2- DRILLED FOR 2 FIXTURES AT 90° & 180°
D3- DRILLED FOR 3 FIXTURES
D4- DRILLED FOR 4 FIXTURES

DRILL MOUNT OPTIONS

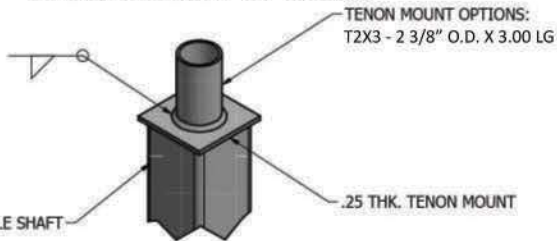

TENON MOUNT OPTIONS:
T2X3 - 2 3/8" O.D. X 3.00 LG

TENON MOUNT OPTIONS

.25 THK. TENON MOUNT

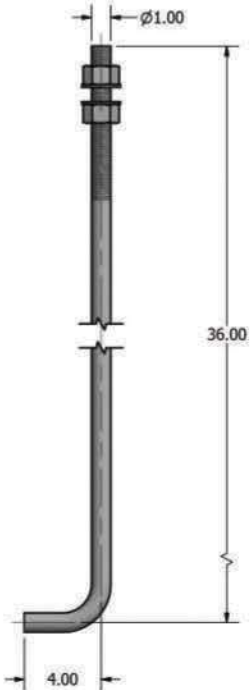

Ø1.00 X 40.00 ANCHOR BOLT

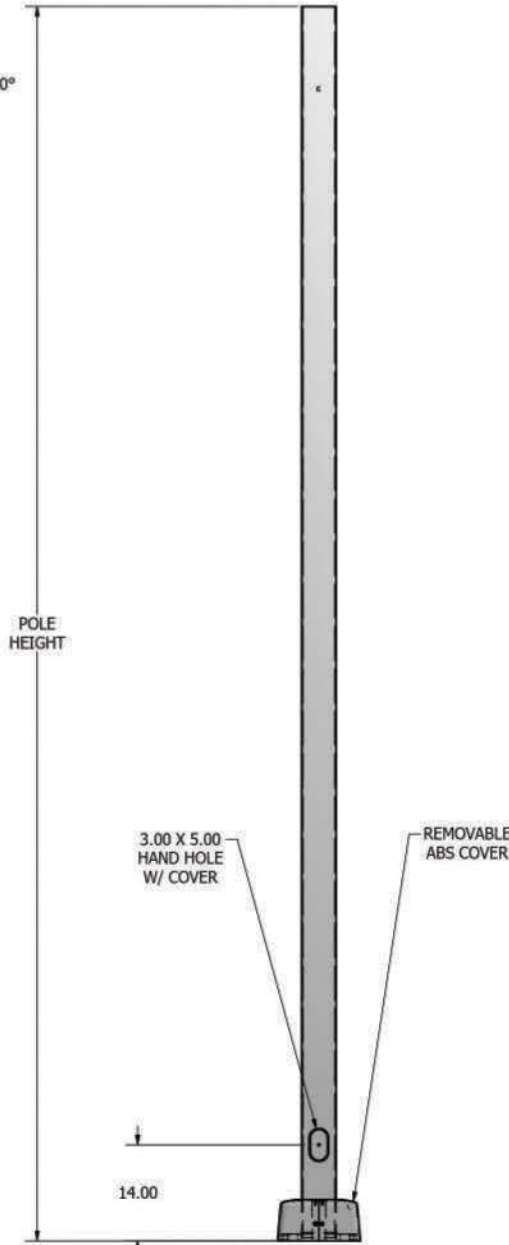

POLE DETAIL

| POLE SPECIFICATIONS | | | | | |
|--|-----------------------|--------------------------|--------------------|-----------------|---------|
| NO. | COMPONENT | ASTM DESIGNATION | MIN. YIELD (P.S.I) | | |
| 1. | POLE SHAFT | A-500 GR. B | 46,000 | | |
| 2. | BASE PLATE | A36 | 36,000 | | |
| 3. | ANCHOR BOLTS | F1554 GR. 55 | 55,000 | | |
| 4. | GALVANIZED HARDWARE | A153 | - | | |
| FINISH SPECIFICATIONS | | | | | |
| POLES SHALL HAVE A POLYESTER POWDER COAT FINISH IN A STANDARD COLOR. | | | | | |
| POLE DIMENSIONS | | | | | |
| POLE HGT. (FT.) | TOP SQ. SIZE (IN.) | BOT. SQ. SIZE (IN.) | GAGE | MTG. HGT. (FT.) | |
| 30' | 5.00 | 5.00 | 7 GAGE | 30' | |
| BASE PLATE DIMENSIONS | | | | | |
| BOLT CIRCLE (IN.) | BASE PLATE DIM. (IN.) | BOLT HOLE (IN.) | PLATE THK. (IN.) | | |
| 10.50-11.50 | 11.00 SQ | 1.25 | 1.00 | | |
| ANCHOR BOLT DIMENSIONS | | | | | |
| ANCHOR BOLT DIA. (IN.) | | ANCHOR BOLT LENGTH (IN.) | | | |
| 1.00 | | 40.00 | | | |
| ALLOWABLE WIND LOADING (SQ. FT.) | | | | | |
| WIND* EPA | INDICATED EPA | 80 MPH | 90 MPH | 100 MPH | 120 MPH |
| | | 10.6 | 8.6 | 6.9 | 4.9 |

*WITH 1.3 GUST FACTOR



3.00 X 5.00 HAND HOLE COVER

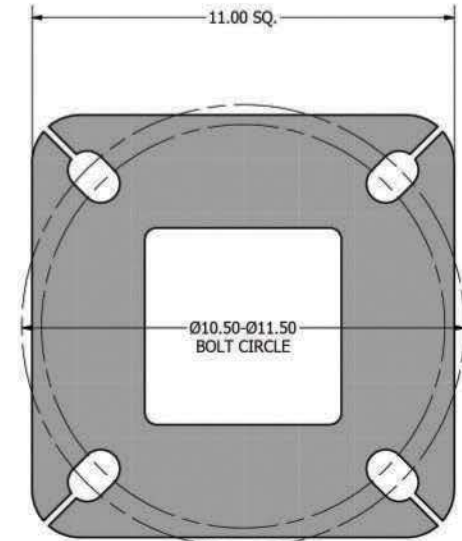

11.00 X 11.00 X 1.00 THK. BASE PLATE

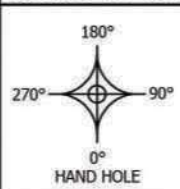

| | |
|-----------|-------------|
| DRAWN: | 1/27/2015 |
| CHECKED: | |
| REVISION: | DATE: |
| APPROVED: | |
| QUOTE: | |
| S.O.# | |
| REF: | SCALE: NONE |



SOME GEOGRAPHICAL AREAS HAVE SPECIAL WIND CONDITIONS THAT CAN CREATE WIND INDUCED VIBRATIONS CAUSING A FATIGUE PROBLEM. NO METHOD HAS YET BEEN FOUND FOR PREDICTING DESTRUCTIVE LIGHTING POLE VIBRATION. THESE CONDITIONS ARE UNIQUE AND CANNOT BE GUARANTEED AGAINST, AND ARE THE RESPONSIBILITY OF A LOCAL SITE ENGINEER.

| | |
|----------|---------------|
| TITLE: | |
| CATALOG: | |
| DWG NO: | U-SSSS-30-5-7 |
| SIZE: | C |
| SHEET | 1 OF 1 |